



Environmental Information for Customers in the European

Union European Directive 2002/96/EC requires that the equipment bearing this symbol on the product and/or its packaging must not be disposed of with unsorted municipal waste. The symbol indicates that this product should be disposed of separately from regular household waste streams. It is your responsibility to dispose of this and other electric and electronic equipment via designated collection facilities appointed by the government or local authorities. Correct disposal and recycling will help prevent potential negative consequences to the environment and human health.

For more detailed information about the disposal of your old equipment, please contact your local authorities, waste disposal service, or the shop where you purchased the product.

Sales & Technical Helplines

Our Sales & Technical helplines are open
Monday to Friday from 8.00am to 5.00pm

SALES



++44 (0)1604 589414 (and press option 1)



info@ultrasecuredirect.com

TECHNICAL



++44 (0)1604 589414 (and press option 2)



technical@ultrasecuredirect.com

ULTRA SECURE LTD,

9-10 RYEHILL COURT,

LODGE FARM I/E, NORTHAMPTON, NN5 7EU

UNITED KINGDOM

www.ultrasecuredirect.com

UltraSecure

PROTECT 800

800m Wireless Driveway Alert

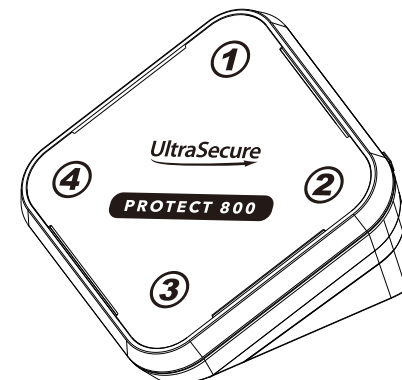

User Manual

Your Driveway Alarm System's Receiver

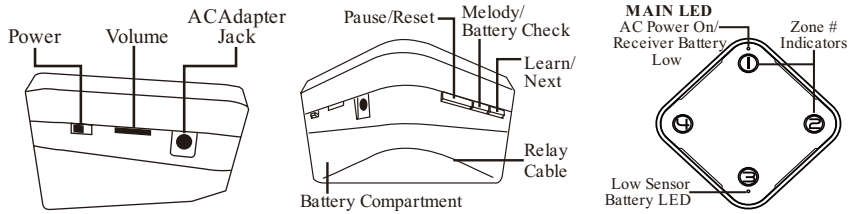

Power: Turns the power on or off.

Volume: Adjusts the Volume of the Alert Chime.

AC Adapter Jack: Plug in the supplied 12V/500mA adapter here.

Pause/Reset: To activate the PAUSE operation or to RESET. See Page 3's Helpful Tip on clearing/resetting an entire zone.

Melody/Battery Check: See Page 4 on choosing a melody. See Page 9 for battery check functions.

Learn/Next: See Page 3, Pairing your Sensors with a Receiver.

AC Power On: The LED above Zone 1 will turn BLUE when using AC Power.

Battery Operate: The LED above Zone 1 will turn RED when operating off of the 4 AA batteries.

Receiver Battery Low: LED above Zone 1 will flash RED every 5 sec. when receiver batteries are running low.

Low PIR Battery LED: LED below Zone 3 will flash RED when one or

Power the system AC Adapter Information

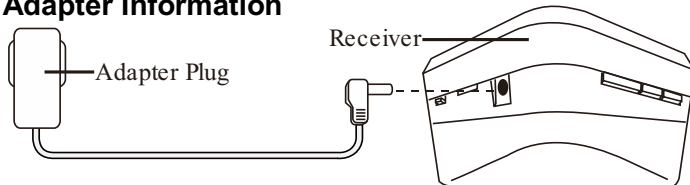

The main power source of the receiver unit is 12V/500mA AC/DC adapter.

Installing Receiver backup Batteries

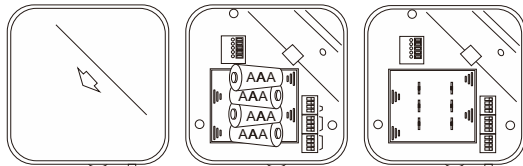

1. Slide panel to open battery compartment.
2. Install four (4) AAA batteries as indicated.
3. Replace cover.

NOTE: The receiver is equipped with a "Low Battery" alert for both the Receiver and the PIR. The alert will re-set when the low batteries are replaced.

B. **Pause Time Setting:** Halts receiver operation for an extended time of either 30 or 60 minutes. (See Section C for instructions on pausing.)

C. **Pause Mode:** In EU Mode, the receiver will automatically turn on after the pause has timed out. In US Mode, the receiver will BEEP when the pause time is over, but will NOT automatically turn on.

D. **Output Timer Setting:** Adjusts the duration time of the 12V output duration time. Example: If set at 1 second, the 12V output will give out a 12V for 1 Second when the sensor is triggered and the chime sounds.

E. **12V Output Control:** Assigns a zone to the 12V Output terminal ("A") for externally wired devices. See A, Output Terminal, on Page 10 for details.

F. **NO/NC Control:** Selects which zone will connect with the NO/NC terminals.

Manufacturer Default Settings

Listed below are the factory settings for your driveway alarm system. NOTE: Your system has been preset by the manufacturer to the most commonly used settings. It is recommended that users test the unit(s) under the default settings before making adjustments. If you have questions about these settings, please contact Customer Service.

Pause Time	30 minutes
Pause Mode	EU
OutputTimer	1 second
12V Outputs	all OFF
NO/NC Control	all OFF

Advanced Settings: Receiver Switches & External Devices

NOTE: Your unit has been set by the manufacturer to the most commonly used set-tings. It is strongly suggested that the system be used first under its factory settings before adjusting the dip switches. If you are connecting an external device to the receiver, consult with the external device's user manual for installation details and parameters. The receiver battery cover must be removed in order to access the dip switches and output terminals (see Section E). Use a pen or other hard, narrow object to move the switches to your preferred setting

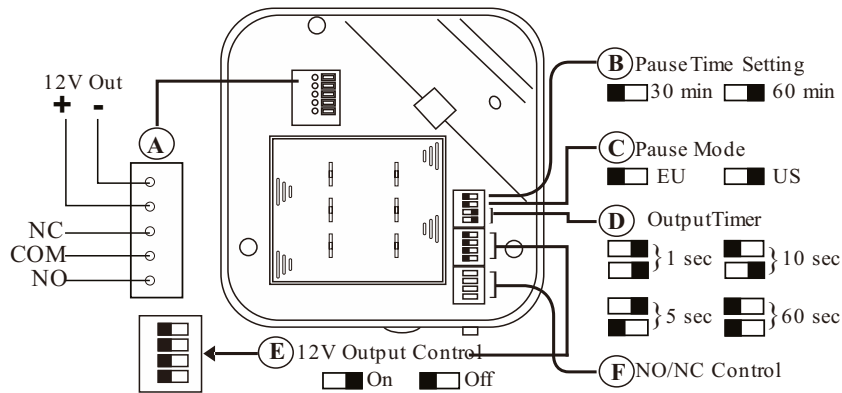

A. Output Terminal: External devices, such as gate openers, door releases, Sirens, Strobes or Bells, can be wired to the receiver using the 12V out relay.

- 12V Out: This terminal outputs 12V/300mA when the selected zone has been triggered in cooperation with "E" (12V Output Control). **This function is dis-abled when running on batteries.** Select which zone relays to this output by sliding ONE of the dip switches for zones 5, 6, 7, or 8 to the "On" position. **The 12v output can be set to 1, 5, 10 or 60 seconds**
- NO (Normal Open): Outputs to a closed circuit when the selected zone has been triggered.
- COM: Neutral/Grounding terminal.
- NC (Normal Closed): Outputs to an open circuit when the selected zone has been triggered.
- The NO and NC outputs cooperate with "F" (NO/NC Control). You can select which zone relays to these outputs by sliding ONE of the dip switches 9, 10, 11, or 12 to the "On" position. **These Relays have a Momentary action**

Pairing your Sensors with a Receiver

Your sensor(s) need to be paired with a receiver before your system can be used. Follow these steps to pair sensor(s) with a receiver unit. Press and hold "Learn" on the receiver for 3 seconds to enter Learn Mode. The Zone 1 indicator will flash.

You have 20-30 seconds to move on to the next stage to avoid a timeout

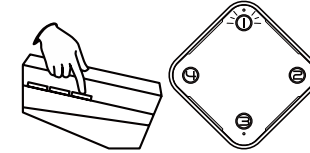

Press "Next" to light the zone indicator you wish to pair your sensor with. (If pairing Zone 1, skip this step.) Each zone's indicator will light when selected. Each zone can be paired with up to four (4) sensors. NOTE: If all spaces are occupied, all zone LEDs will flash THREE TIMES.

You have 20-30 seconds to move on to the next stage to avoid a timeout

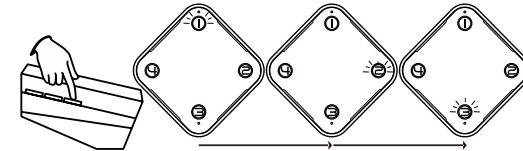

3. Keep pressing the "Melody" button to choose the melody you wish to play when the sensor is triggered.

There are a total of 32 melodies to choose from. Melody select sequence: Melody 1 > Melody 2 > ... > Melody 32 > Melody 1...

To complete the process, activate the sensor you wish to pair by slowly walking past or waving your hand at least one foot from the eye. The sensor eye will light when activated. The receiver will BEEP when successfully paired. To exit Learn Mode, press "Next" until all zone indicators turn off. (or switch the receiver off and back on again)

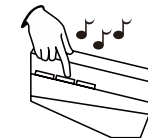

NOTE: If the sensor has already been paired there will be NO SOUND. The indicator of the already paired zone will flash, then the indicator of the new zone chosen in Step 2 will relight. You need to select a different zone to complete the pairing process. Helpful Tip! Clearing All the Sensors in a Zone

1. Press and hold "Learn" for 3 seconds to enter Learn Mode.
2. Press "Next" to select which zone you wish to unpair. (If clearing Zone 1, skip this step)
3. Press and hold "Pause/Reset" for 3 seconds to unpair all the sensors in that zone. The receiver will BEEP when the zone has been unpaired.
4. Press "Next" until all indicators are off to exit Learn Mode.

Mounting the Receiver on the Wall

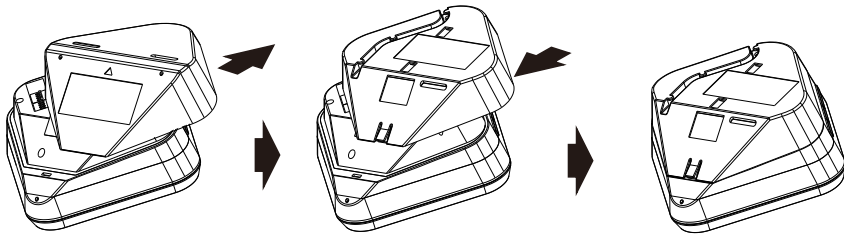

Remove the original Battery Cover and replace with the wall mounting cover

Fix the wall bracket provided

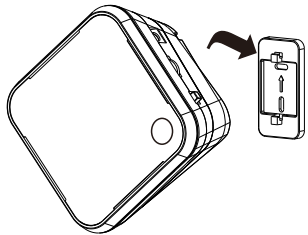
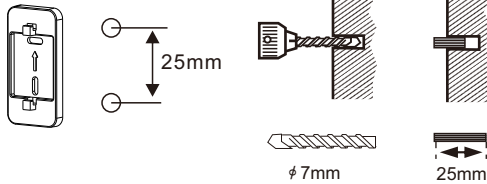

Hook the Receiver onto the wall bracket

Tap the battery cover to attach the Receiver to the wall bracket
(Do not press the receiver body)

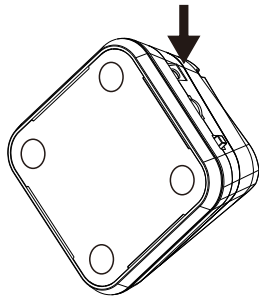

Checking Sensor Battery Strength

All sensor batteries should be checked frequently to prevent malfunction of the alarm system. Check the sensor batteries by using the receiver's "Battery Check" button and following the instructions below.

1. Press and hold "Battery Check" for 3 seconds to enter Check Mode. The MAIN RED LED will light. (Situating below zone 3 indicator)

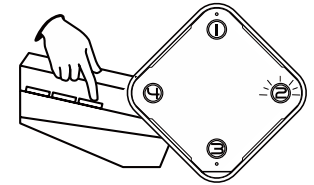
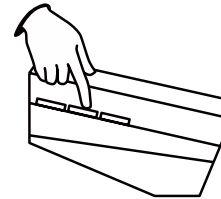

2. Press "Next" to select the zone you want to check. (The chosen zone LED will illuminate)

3. Press and hold "Battery Check". The illuminated zone LED will go out while you hold the button in if the batteries are good, if there is a low battery zone LED's 1 to 4 will illuminate whilst the button is held down.

If a zone LED is illuminated whilst the Battery Check button is held in, this will be indicating which PIR in the zone being checked is low (example the first PIR to be paired into a zone will be showed as zone 1, the second PIR to be paired into a zone will show as zone 2).

4. Release button. Repeat Steps 2 & 3 to check remaining zones.